



# LEGAULT HOMES CABINETS

MID SOUTH BUILDING SUPPLY

UPDATED FEBRUARY 2024

# DOOR STYLES

MARIMAC

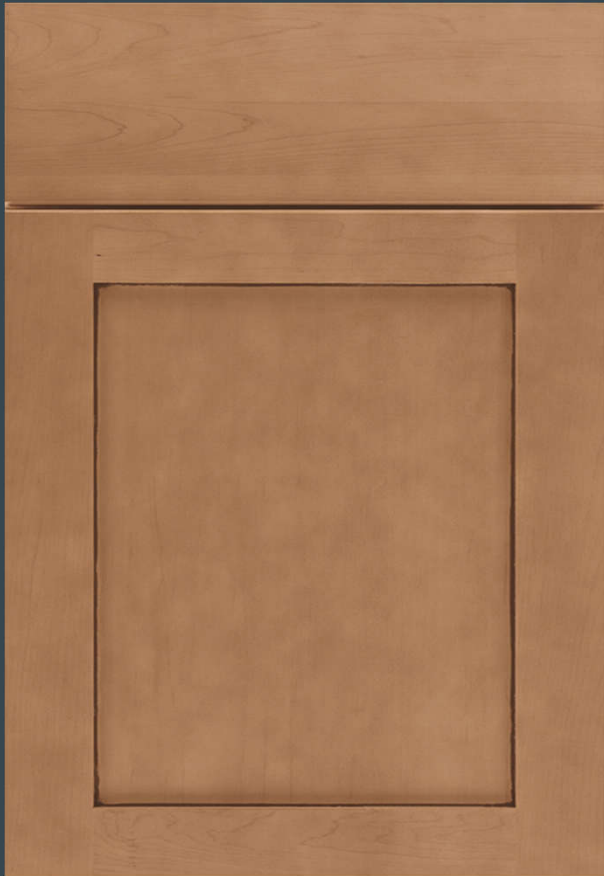

KLEYBORN

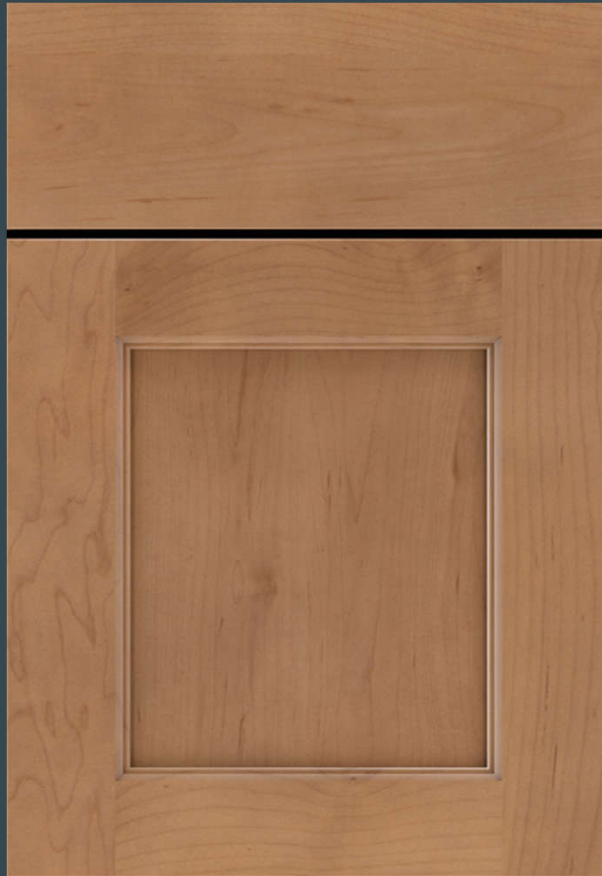

WILLOWBY



# MARIMAC SPECIFICATIONS

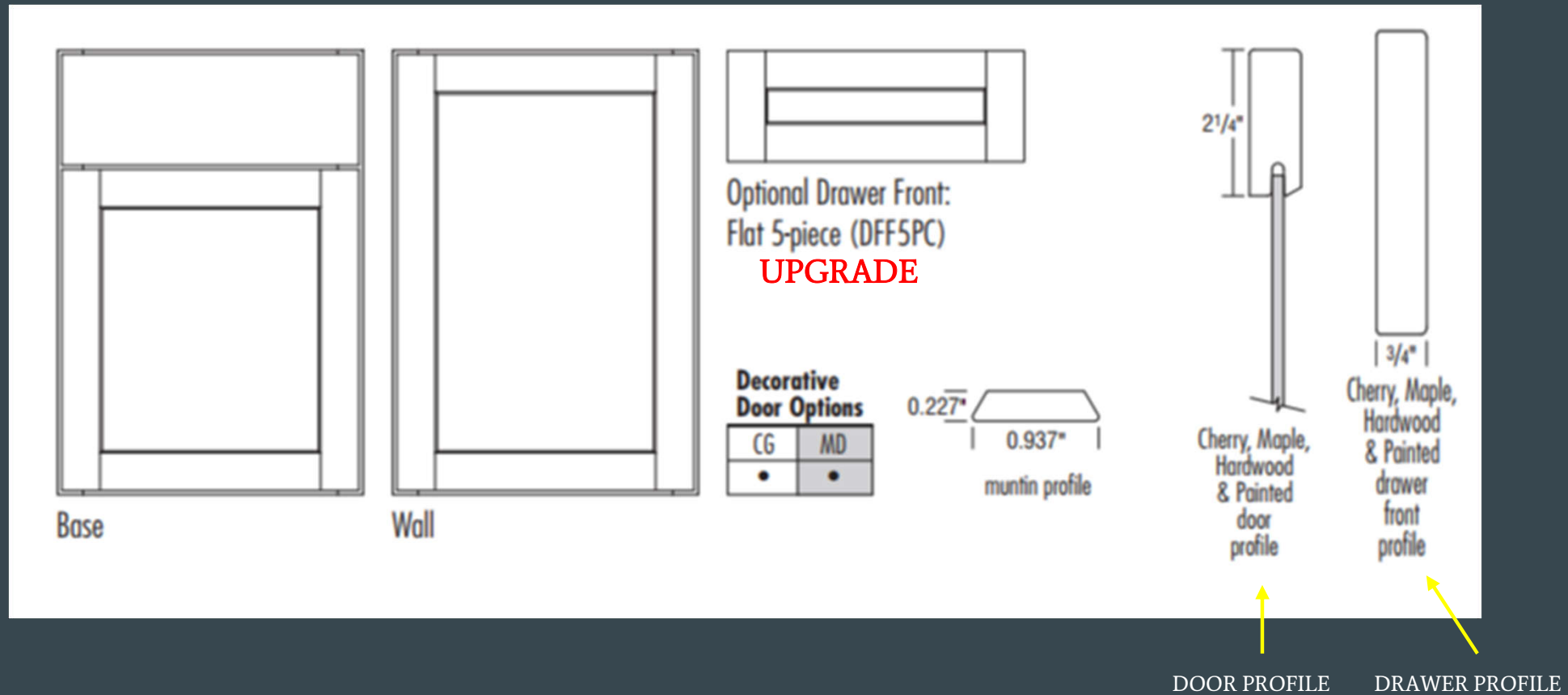

# KLEYBORN SPECIFICATIONS

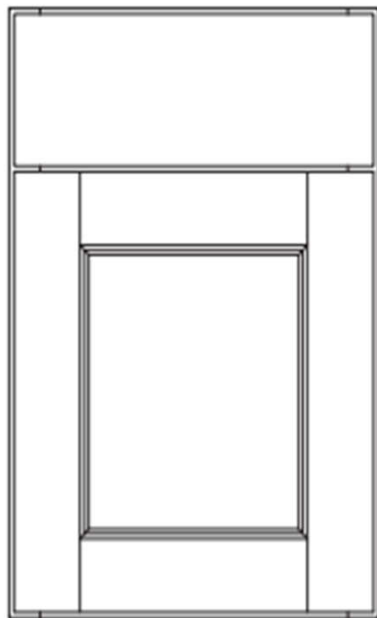

Square Base

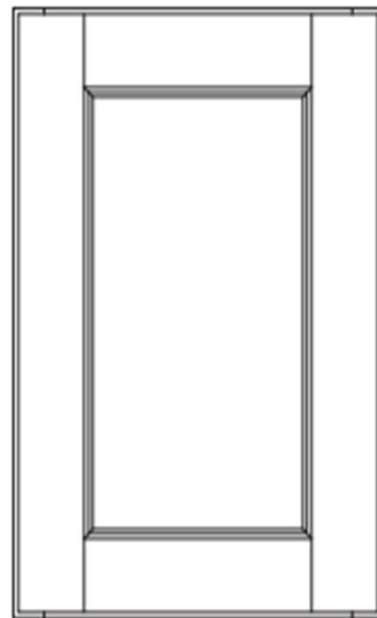

Square Wall



Optional Drawer Front:  
Flat 5-Piece (DFF5PC)  
**UPGRADE**

## Decorative Door Options

CG	MD
•	•

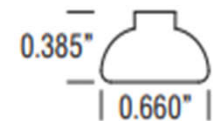

muntin profile



door profile



drawer front profile

DOOR PROFILE

DRAWER PROFILE

# WILLOWBY SPECIFICATIONS

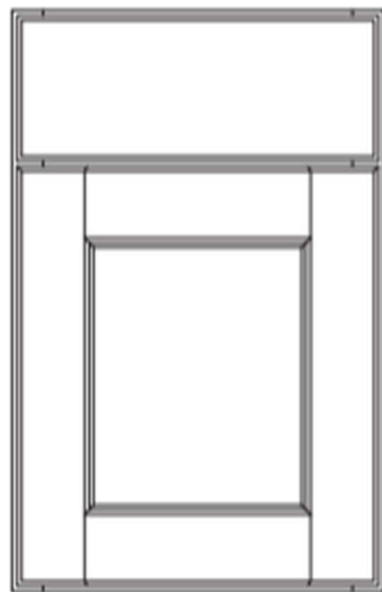

Base

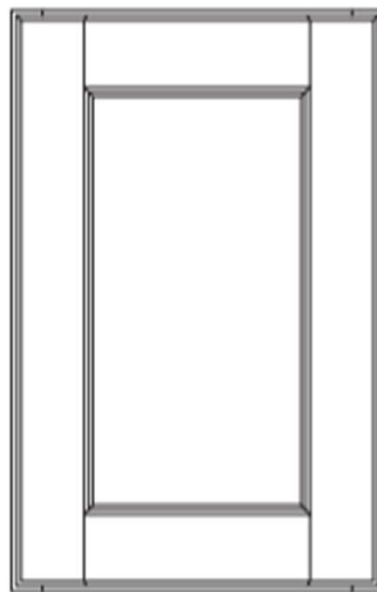

Wall



Optional Drawer Front:  
Flat 5-piece (DFF5PC)

**UPGRADE**

**Decorative  
Door Options**

CG	MD
•	•

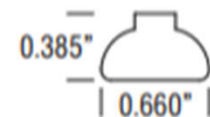

muntin profile



door  
profile



3/4"  
drawer  
front  
profile

DOOR PROFILE

DRAWER PROFILE

# CABINET CONSTRUCTION

## ECHO STANDARD BOX CONSTRUCTION

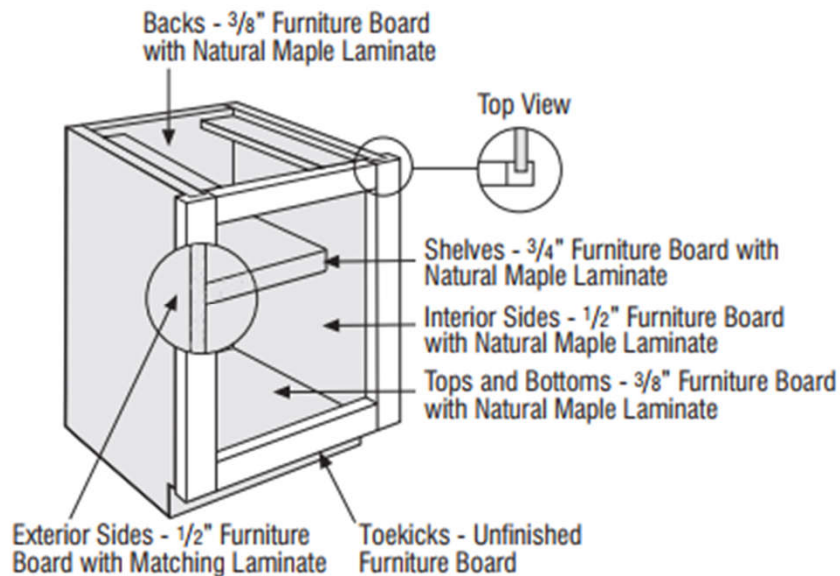

## ECHO STANDARD DRAWER BOX CONSTRUCTION

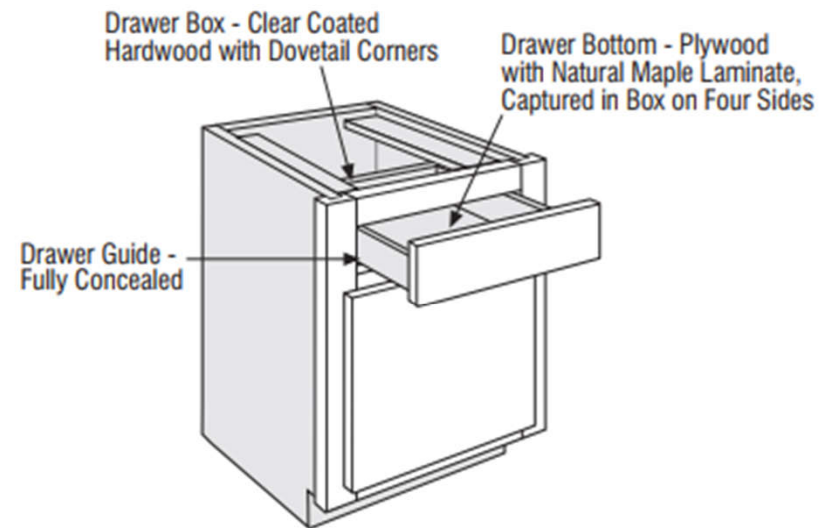

Smart Stop™ fully concealed, integrated cup hinge with self-closing feature; 6-way adjustable. Hinge features deactivation option. Some cabinets utilize a  $170^\circ$  or  $107^\circ$  4-way adjustable hinge

## LEVEL 1



## FINISH OPTIONS

NATURAL

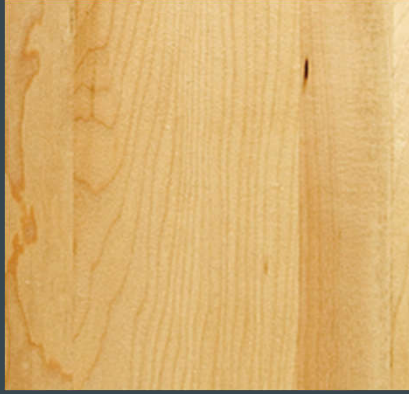

BUCKSKIN



COLT



CHOCOLATE

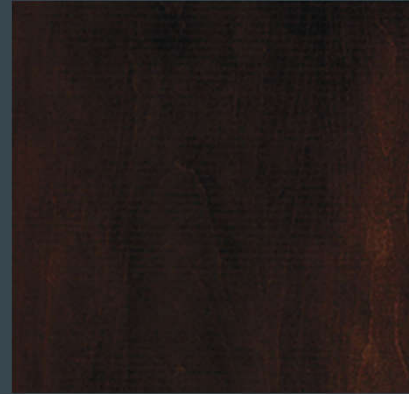

LEVEL 2



FINISH OPTIONS

SAHARA



MOREL



THATCH



KANGA



TITANIUM





LEVEL 3



FINISH OPTIONS

WHITE



ICY AVALANCHE



STEAM

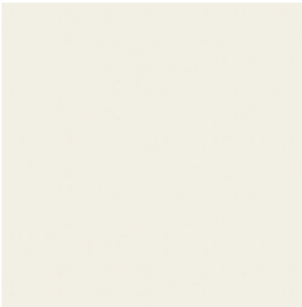

BLACK

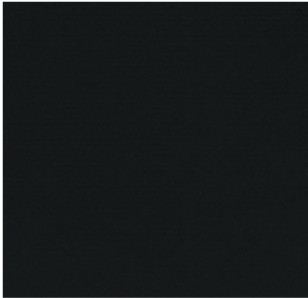

RETREAT

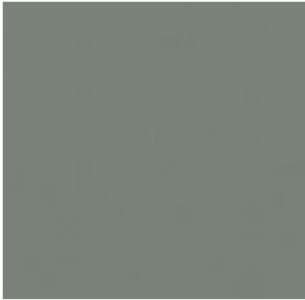

CLOUD



MOONSTONE



MARITIME



NAVAL



## LEVEL 4



## FINISH OPTIONS

BRIGHTEST WHITE

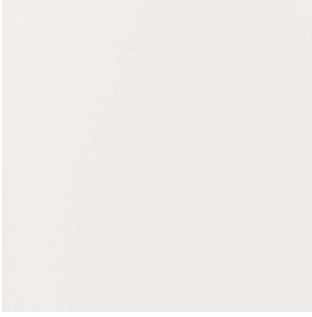

ABYSS

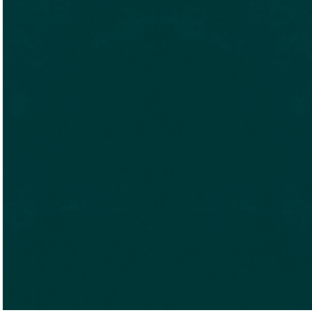

SEA SALT

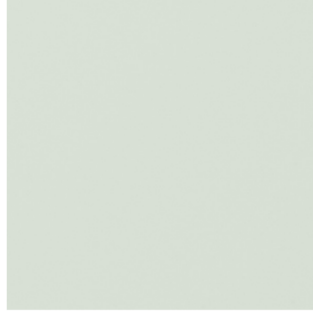

COASTAL PLAIN



INTERESTING AQUA

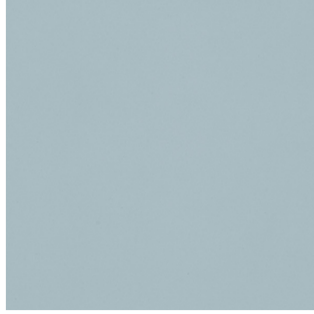

DISTANCE

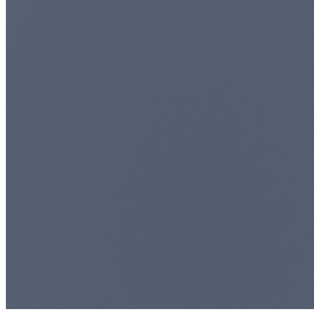

BOARDWALK



FOX HALL GREEN

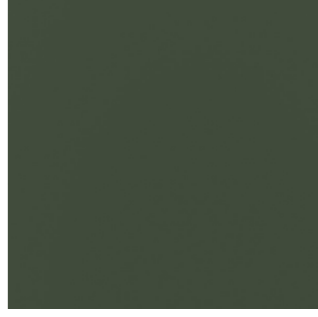

# FURNITURE VANITY

WHITE ICING

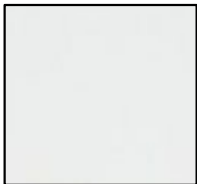

GRAY OWL



EARL GRAY

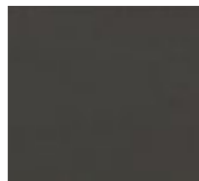

SANDPIPER



BISCOTTI



DOCKSIDE



HEARTH

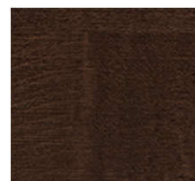

GALE



CELESTE

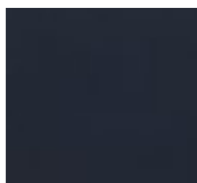

ALOE



EUCALYPTUS



ADDITIONAL COLORS & STAINS IN SHOWROOM

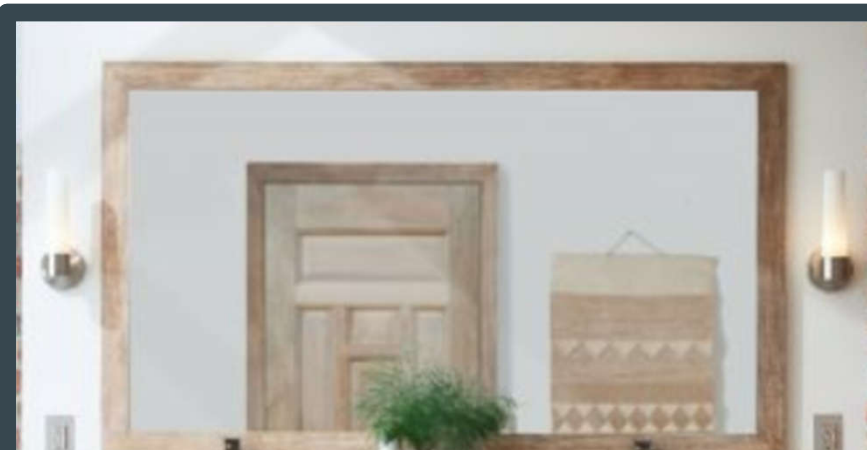

SOLARE COLLECTION



UPGRADE

# KITCHEN ISLAND

## STANDARD

- STANDARD ISLAND SIZE 72" x 48"  
24 SQFT TOTAL
- INCLUDES DISWASHER & SINK  
IN ISLAND
- NO CABINETRY INCLUDED ON  
BACK OF ISLAND

OPTION FOR ADDITIONAL CABINETS ON  
BACK OF ISLAND IS AN UPGRADE



SIDE VIEW OF  
STANDARD ISLAND



BACK VIEW OF  
STANDARD ISLAND

# TRASH UPGRADES

➤ SINGLE TRASH PULL OUT

➤ DOUBLE TRASH PULL OUT

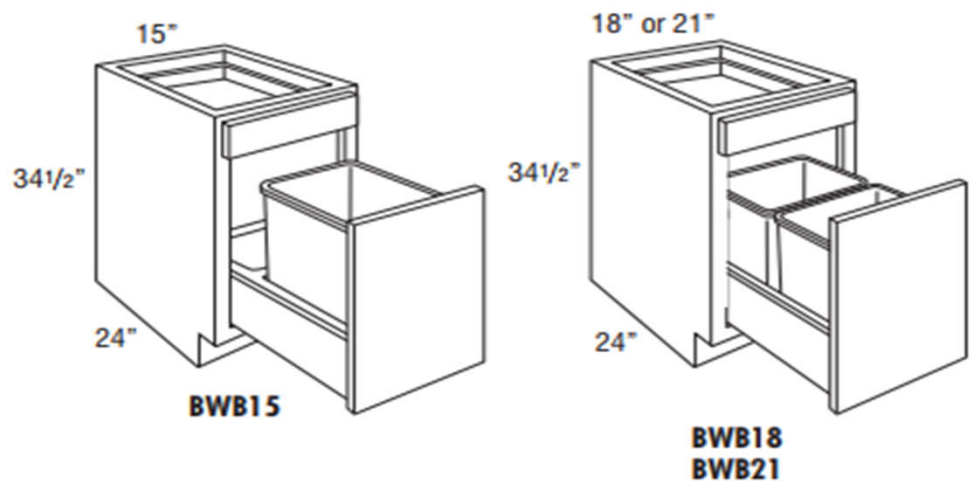

# SPICES

## UPGRADES

➤ WALL CABINET SPICE PULL OUT

➤ BASE CABINET SPICE PULL OUT

BASE

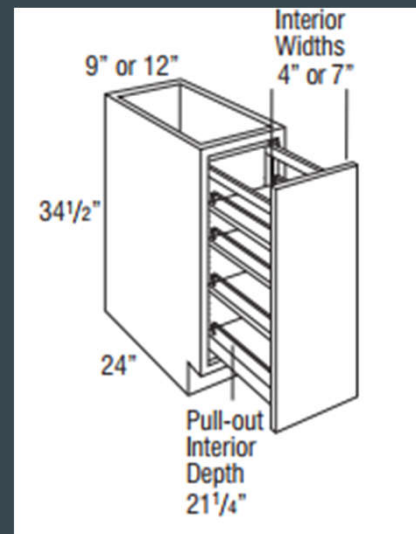

WALL

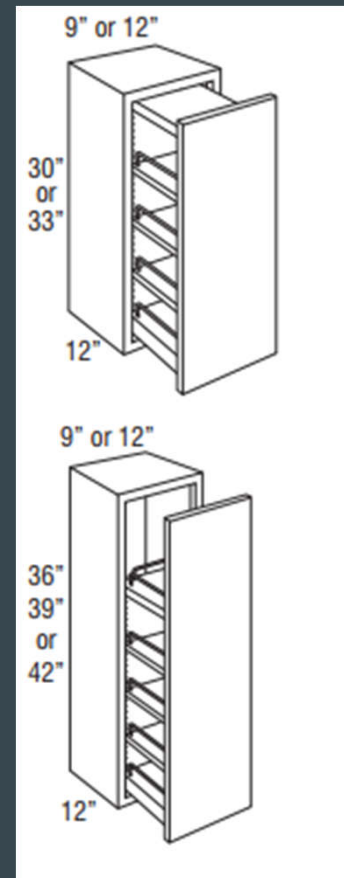

# UTENSILS

## UPGRADES

➤ UTENSIL PULL OUT

➤ UTENSIL PULL OUT WITH KNIFE BLOCK

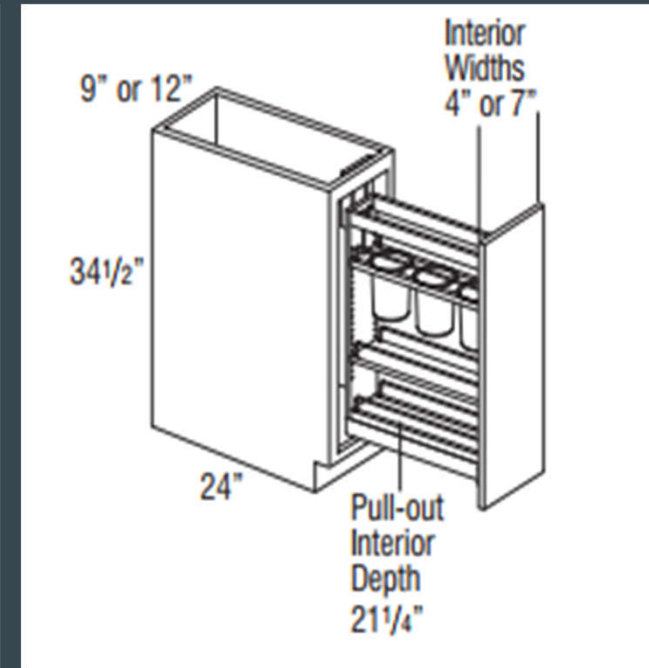
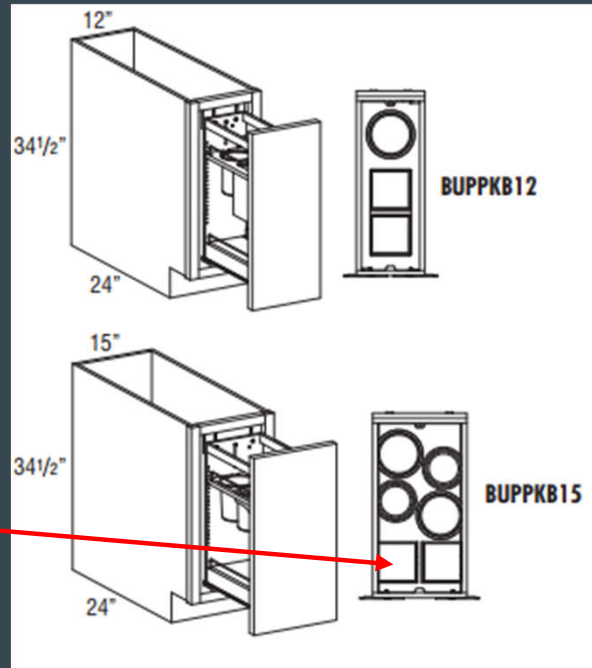

# ROLL OUTS

## UPGRADES

➤ (2) ROLL OUT TRAYS

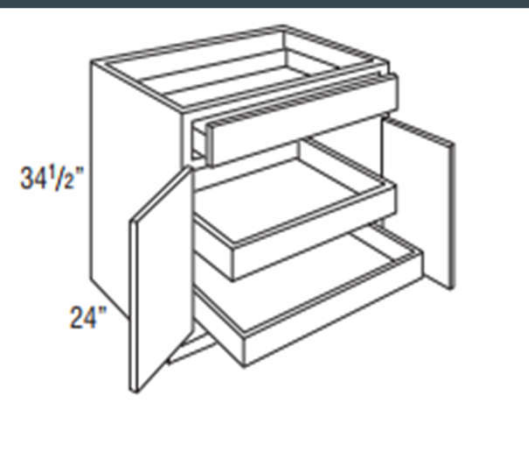

➤ (2) ROLL OUT TRAYS WITH  
WOOD TIERED CUTLERY  
DIVIDER DRAWER

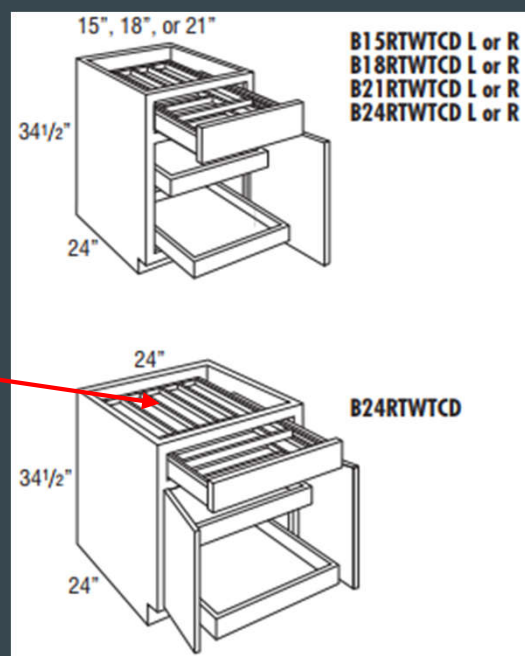



# GLASS UPGRADES

➤ SINGLE DOOR  
Includes finished interior\*

➤ DOUBLE DOOR  
Includes finished interior\*

➤ GLASS SHELVES  
Also available in diagonal\*



# PANTRY

## UPGRADES

➤ FIXED SHELVES

➤ ROLL OUTS

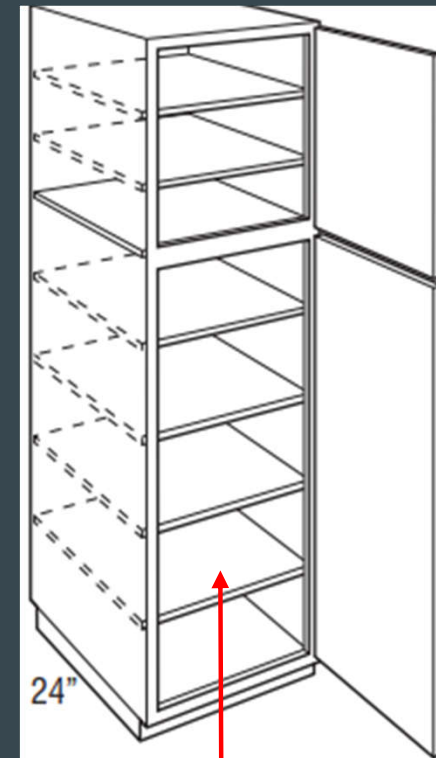
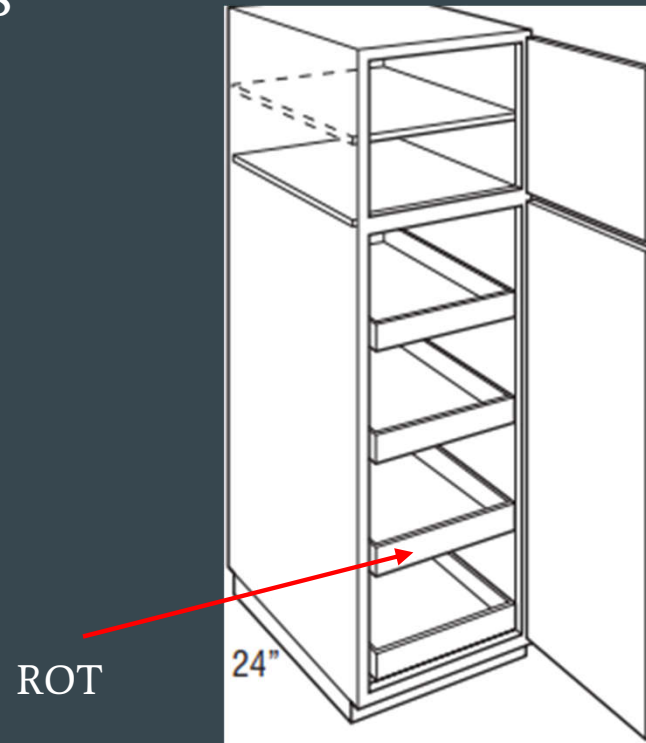

FIXED  
SHELVES

# LINENS

UPGRADES

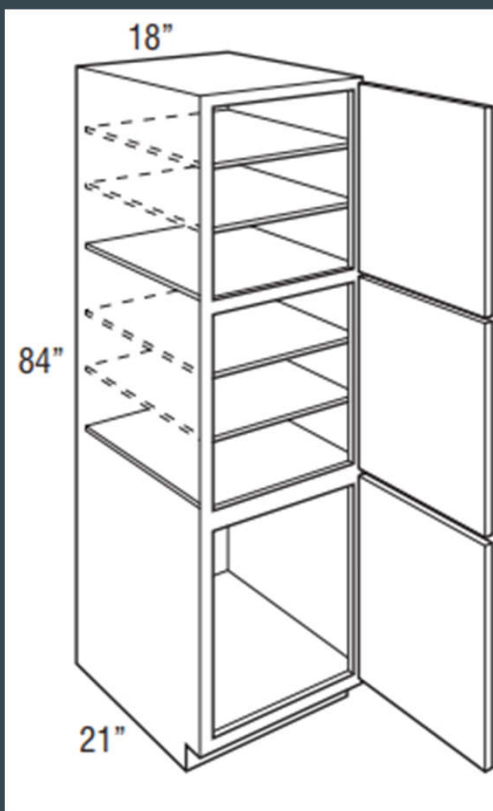

VANITY UTILITY

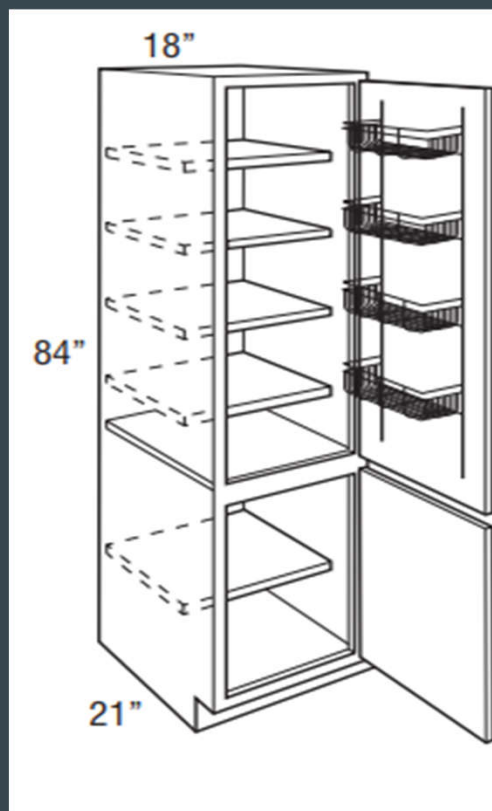

LINEN CLOSET

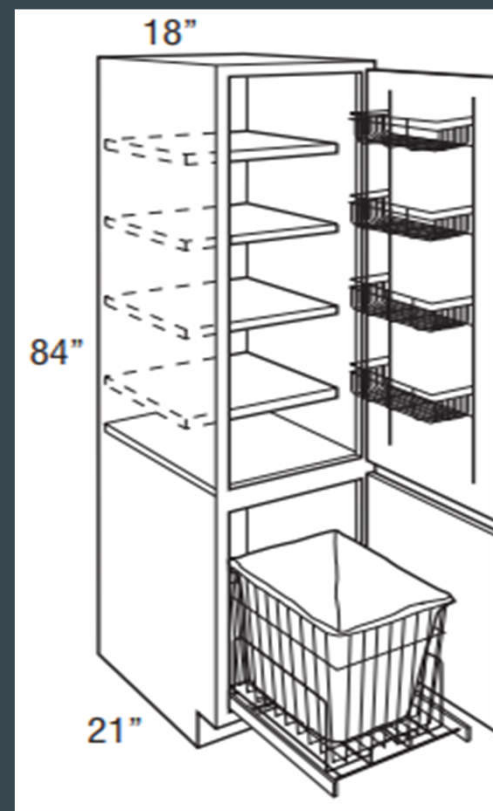

LINEN WITH  
REMOVABLE HAMPER

➤ **2 DRAWER BANK**  
(OPTION FOR TOP DRAWER  
ROLL OUT TRAY)

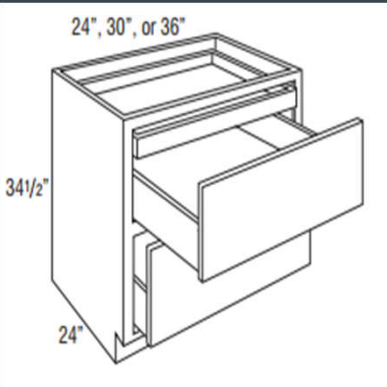
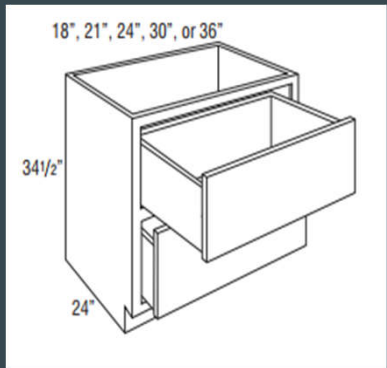

➤ **3 DRAWER BANK**  
(OPTION FOR TOP DRAWER  
WOOD TIERED CUTLERY DIVIDER)

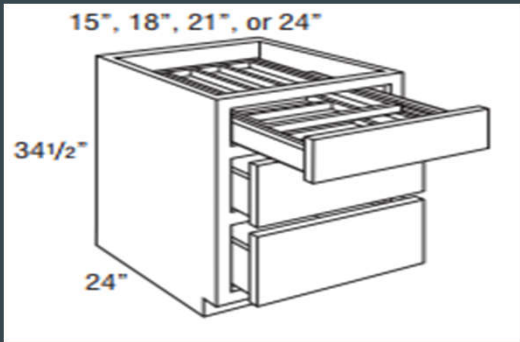
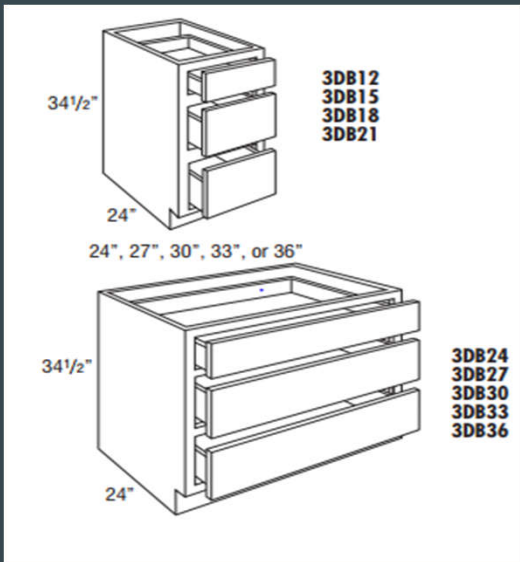

➤ **4 DRAWER BANK**  
(OPTION FOR TOP DRAWER  
WOOD TIERED CUTLERY DIVIDER)

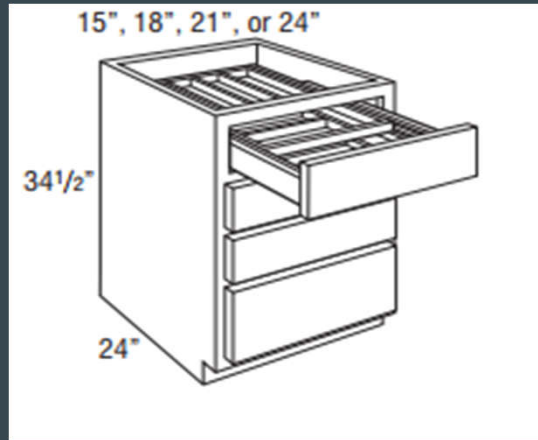
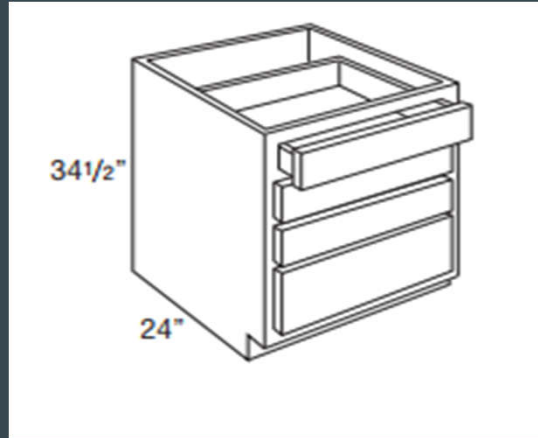

**DRAWERS**

**UPGRADES**

# ORGANIZE

## UPGRADES

➤ SINK TILT-OUT AND CAB MAT

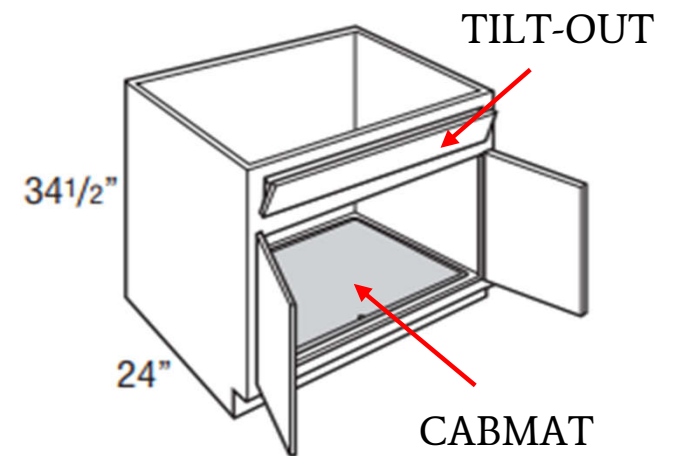

➤ SUPER CABINET

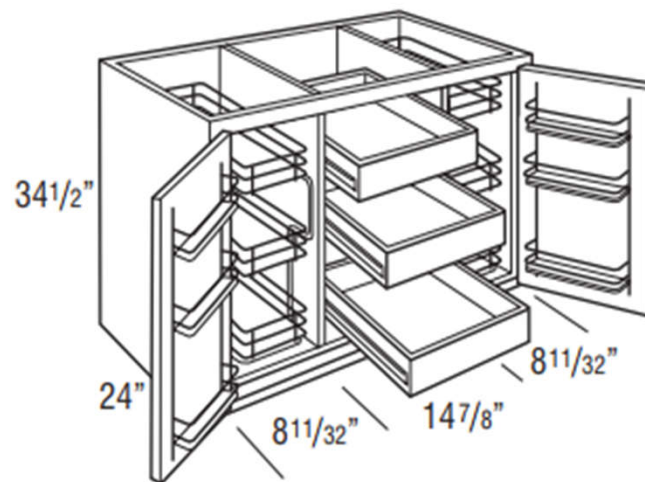

# WOOD HOODS

## UPGRADES



CLASSIC SQUARE



SHIPLAP TAPERED



SIMPLE TAPERED

# DECORATIVE ADDITIONS



TAPERED LEGS & VALANCE

FLOATING  
SHELVES



DECORATIVE  
END PANEL



TAPERED FEET

UPGRADES



# DECORATIVE ADDITIONS



CABINETS ON BACKSIDE OF ISLAND



X PATTERNS ON  
END OF ISLAND



5 PC DRAWER FRONTS IN  
LIEU OF SLAB DRAWERS



UPGRADES



## HOW TO CARE FOR YOUR CABINETS

<https://www.masterbrand.com/care-and-cleaning>

## HOMEOWNER WARRANTY

<https://www.kempercabinets.com/warranty>

